

CTX-CTL Pressure Transmitter for OEM Applications

OEM applications

Excellent price/performance ratio

Compact and light-weight

CE conformity

Output signals: 4...20 mA, 0...10 Vdc, 1...5Vdc, 0.5...4.5 Vdc

Automated laser setting

Stainless Steel (CTX) or brass (CTL) construction



Series CT transmitters are designed for extremely diverse industrial applications: ventilation, heating, pumps, pressure measurement on water systems (building complexes, etc.), maintaining pressure setpoints on oil compressors, integration in production machinery, agriculture machines, etc.

OEM Markets: machine equipments, water treatment, water distribution, energy (diesel engines, cogeneration plants), automatic sequence control, etc.

Specifications (20°C)

Measurement range	CTX: from -1...1.5 to 0...200 bar, gauge pressure CTL: from -1...1.5 to 0...40 bar, gauge pressure	Standard connections CTX	Electrical: DIN 43650 connector, pig tail cable outlet, M12 - 4 contacts plug Pressure: G1/4 EN837, G1/4 DIN 3852-E, G1/2 EN837, 1/4 NPT, 1/2 NPT
Output signal	CTX2 - CTL2: 0...10 Vdc CTX3 - CTL3: 4...20 mA CTX4 - CTL4: 1...5 Vdc CTX7 - CTL7: 0.5...4.5 Vdc under 5 Vdc	Standard connections CTL	Electrical: pig tail cable outlet Pressure: G1/4 EN837, 1/4 NPT
Supply voltage	CTX2 - CTL2: 15...30 Vdc CTX3/4 - CTL3/4: 11...30 Vdc CTX7 - CTL7: regulated 5 Vdc power supply Polarity reversion protection	Protection rating (EN 60529)	IP65
Insulation	> 100 MΩ at 100 Vdc	Typical response time	≤ 3 ms
Load impedance	CTX2/4/7 - CTL2/4/7: ≥ 5 kΩ CTX3 - CTL3: $R_{\Omega} \leq (U_{supply} - 11)/0.02$	Vibration resistance (IEC 68-2-6)	1.5 mm (10 - 55 Hz), 20 g (55 Hz - 2 kHz)
CE Conformity	Directive 89/336 CE Pressure Directive 97/23/CE	Shock resistance (IEC 68-2-32)	25 falls from 1 m on concrete ground
Global error (linearity, hysteresis and repeatability) with reference to BFSL	Typically: ±0.4% of F.S. / Max.: ±0.5% of F.S.	Weight	from 80 g to 150 g depending on versions
Operating temperature		Options	
Ambient (Ta)	-25...+85°C	Other hydraulic connections (quantity ≥ 100 units)	
Fluid	-25...+100°C (Ta ≤ 50°C)	Other electrical connections (quantity ≥ 100 units)	
Storage temperature	-40...+85°C	Other units	
Compensated temperature range (zero and sensitivity)	-10...+55°C	M12 female mobile plug, screw terminal connection (CTX). Code 2260	
Zero thermal drift	±0.025% F.S./°C max.	2 mV/V ±30% output signal: CTX1/CTL1 versions, please consult us	
Span thermal drift	Typically: ±0.01% F.S./°C / Max.: ±0.015% F.S./°C		
Wetted parts	CTX: Ceramic + NBR seal (standard) + 1.4404 (316L) stainless steel CTL: Ceramic + NBR seal (standard) + brass		

Dimensions (mm), connections

DIN 43650 connector

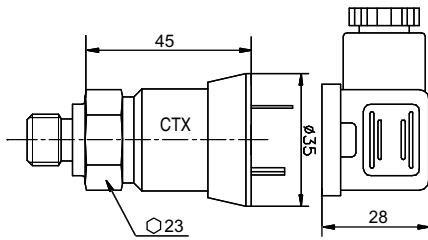

Pig tail cable outlet

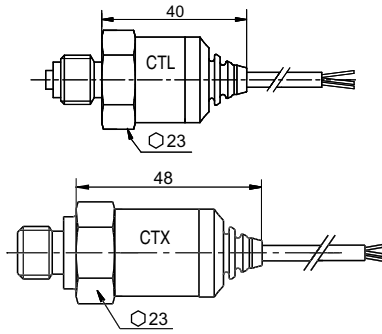

M12 - 4 contacts plug

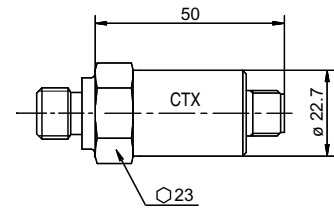

	CTX3	1	+ supply
		2	- supply
		3	ground
	CTX2	1	+ supply
	CTX4	2	- sup. / - meas.
	CTX7	3	+ measurement
		ground	

CTX3	Red	+ supply
CTL3	Black	- supply
CTX2/4/7	Red	+ supply
CTL2/4/7	Black	- sup. / - meas.
	White	+ measurement

	CTX3	1	+ supply
		2	- supply
		3	ground
		4	ground
	CTX2	1	+ supply
	CTX4	2	+ measurement
	CTX7	3	- sup. / - meas.
		4	ground

Hydraulic connection

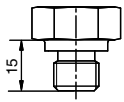

G 1/4 DIN 3852-E

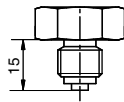

G 1/4 EN837

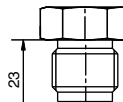

G 1/2 EN837

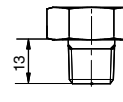

1/4 NPT

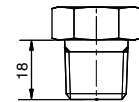

1/2 NPT

Measuring Ranges

Pressure	Pressure in bar										
	2.5	4	6	10	16	25	40	60	100	160	200 ⁽¹⁾
Max. overpressure	4	8	12	20	32	50	80	120	200	320	360
Burst pressure	7	12	18	30	48	75	120	180	300	480	480

specifications at 20°C

Ordering Details - CTX / CTL

Model		CTxxxxxxx									
OEM pressure transmitter, stainless steel construction		1'...3' digit	CTX								
OEM pressure transmitter, brass construction			CTL								
Output signal		4' digit									
0...10 Vdc			2								
4...20 mA			3								
1...5 Vdc			4								
0.5...4.5 Vdc under 5 Vdc regulated			7								
Hydraulic connection		5' digit									
G 1/4			2								
G 1/4 DIN 3852-E *			B								
G 1/2 *			3								
1/4 NPT			5								
1/2 NPT *			6								
Sensor seal		6' digit									
NBR (Nitril) standard			3								
EPDM			5								
FKM (Viton®)			9								
Pressure range		7'...9' digit									
See table			Bxx								
Electrical output		10' digit									
DIN 43650 connector *			0								
Pig tail cable outlet, 1-meter length			1								
Pig tail cable outlet, 2-meter length			2								
Pig tail cable outlet, 5-meter length			5								
M12 - 4 contacts plug *			A								

code	Pressure range in bar
B74	-1 + 1,5
B76	-1 + 3
B77	-1 + 5
B79	-1 + 9
B81	-1 + 15
B82	-1 + 24
B1L	-1 + 39
B18	0 + 2,5
B19	0 + 4
B20	0 + 6
B22	0 + 10
B24	0 + 16
B26	0 + 25
B27	0 + 40
B29	0 + 60 *
B31	0 + 100 *
B33	0 + 160 *
B34	0 +200 *(1)

* Not available in CTL version

(1) Please consult us for operating specifications